

**SEAT RAIL for 1950-58 CUSHMAN EAGLE Part No. 807409 & Part No. 807409-B**

**NOTE:** It is difficult to hold and start the nut inside the spring. It is suggested to use a piece of tape to hold the nut into position.

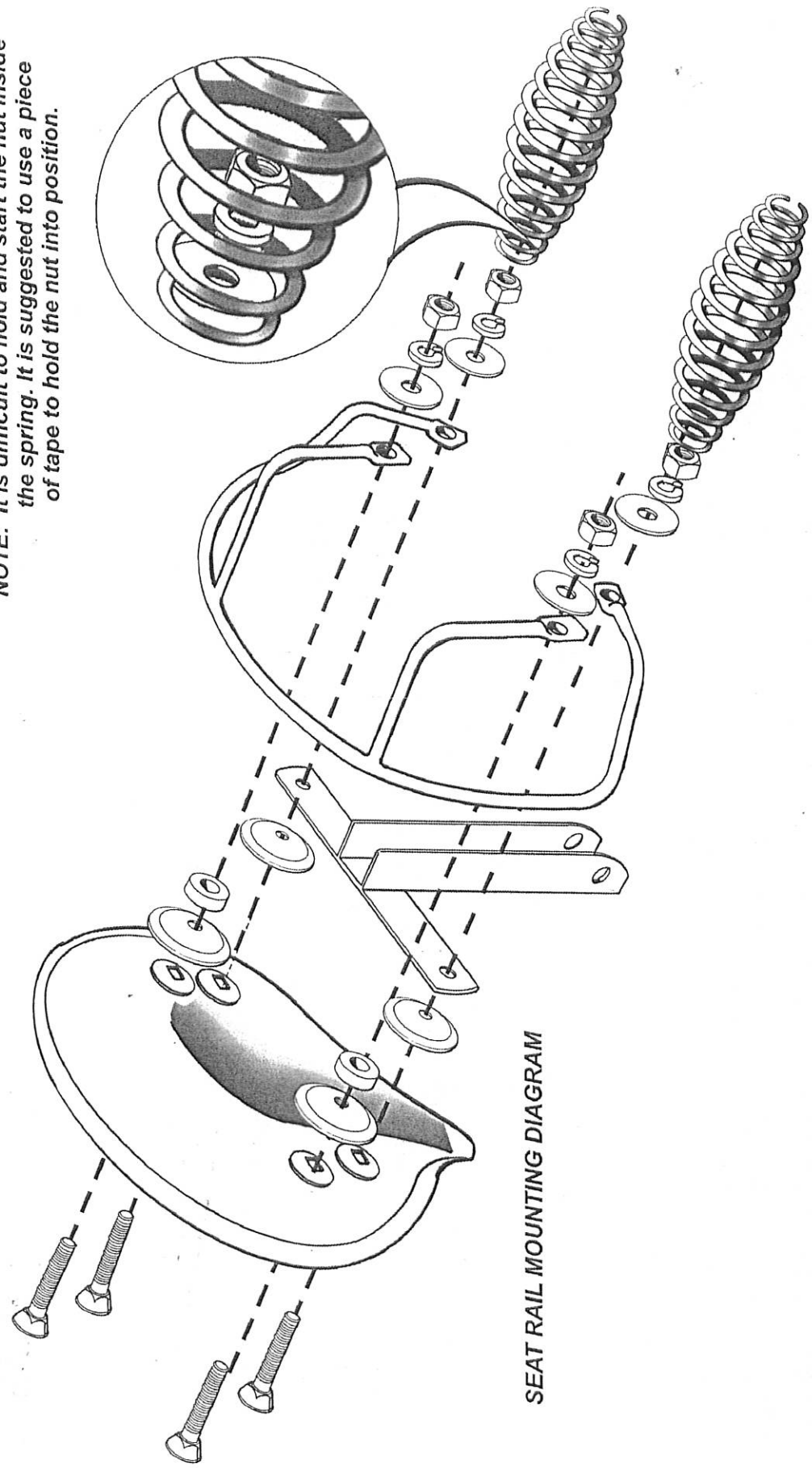

**SEAT RAIL MOUNTING DIAGRAM**



4140 Concord Parkway So., Concord, NC 28027  
(704) 782-1237 email: [info@dennis-carpenter.com](mailto:info@dennis-carpenter.com)  
[www.dennis-carpentercushman.com](http://www.dennis-carpentercushman.com)